

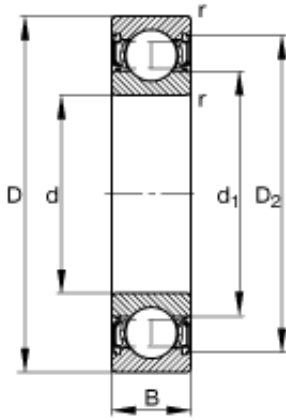

BEARING PRECISION AXLE CORP.



25 mm x 47 mm x 12 mm FAG 6005-2RSR Single Row Ball Bearings

Bearing No. 6005-2RSR

6005-2RSR Bearing 2D drawings and 3D CAD models

Size	25x47x12 mm
Bore Diameter	25 mm
Outer Diameter	47 mm
Width	12 mm
d	25 mm
D	47 mm
B	12 mm
D_2	42,5 mm
$D_{a \max}$	43,8 mm
d_1	32 mm
$d_{a \min}$	28,2 mm
$r_{a \max}$	0,6 mm
r_{\min}	0,6 mm
m	0,085 kg / Weight
C_r	10700 N / Dynamic load rating (radial)
C_{0r}	5900 N / Static load rating (radial)
n_G	10000 1/min / Limiting speed
n_B	1/min / Reference speed
C_{ur}	295 N / Fatigue limit load, radial